

Assembly map for the pendant arm oiling machine (hair drier)

I Installation method for machine head and the pendant arm:

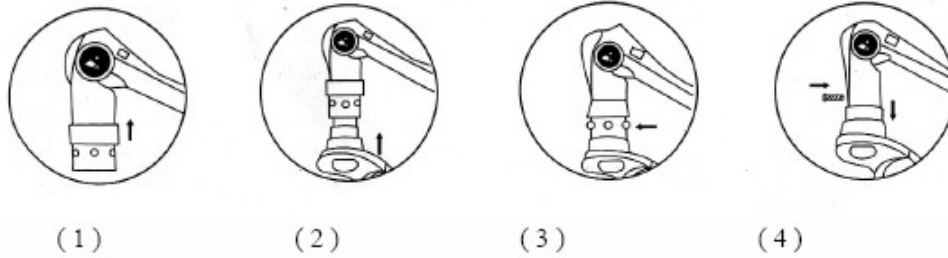

1. Invaginate the stainless steel into the end of the pendant arm and put it above the tiny round hole.
2. Insert the suspending lever of the machine head into the pendant arm until they join each other.
3. Insert four small steel balls stained with oil into the tiny round hold at the end of the pendant arm.
4. Draw the stainless steel ring downward to the end of the pendant arm to join with the suspending lever and fix firmly with small screws.

II Adjustment method for the pendant arm:

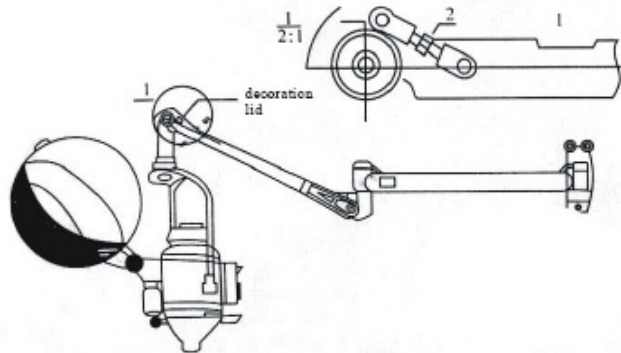

1. Elasticity adjustment: a. if the machine head can not stop at any arbitrary position, the elasticity of the pendant arm should be adjusted. Bb. Work the decoration lid screws

loose, and adjust the screw 1 in the well with special screwdriver (presented with the machine) until the machine head can stop at any arbitrary position.

2. Balance adjustment: a. if the oiling machine is not horizontal enough, its level should be adjusted. Bb. Work the decoration lid screws loose, and adjust with acutilingual clamp the hexangular screw bolt until it is horizontal.

III The installation size and height for the pendant arm

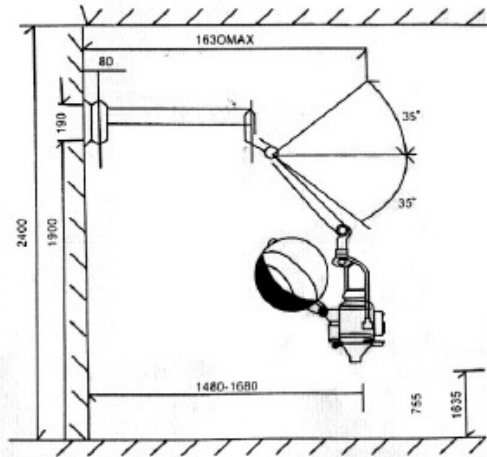

Directions to Loosen Arm Flexibility

Step 1: Locate the plastic cover towards the bottom end of the dryer arm (see picture below)



Step 2: Remove plastic cover by unscrewing the screw that holds it (see image below)



Step 3: Open up the arm using force (may require 2 people) and nut will expose in the uncovered hole. (see image below)



Step 4: Loosen the nut by inserting 4 inch bar tool (included in package) and turning the nut to desired flexibility for the arm. (see image above)

Step 5: Replace cover and mount the arm to the wall. The arm will hold into place when mounted on the wall and positioned where needed.